



Copper Cable Management Solutions



Ethernet Distribution Frame	206
Vertical and Horizontal Cable Management	207
Universal Mounting System	213
Back Mount Frames	218
Rod Mount Frames	221
Mounting Frames	223
Support Bars	224
Inverted Support Bars	225
Jumper Ring Bars	226
Accessories	227



Copper Cable Management Solutions

Ethernet Distribution Frame

ADC's Ethernet Distribution Frame (EDF) forms a central patching location between active Ethernet network elements. By creating a centralized craft interface for adds, upgrades, and rearrangements on Ethernet equipment, the EDF enables change without service disruptions. This central patching location provides a logical and easy-to-manage infrastructure due to two design characteristics:

- All network elements have permanent equipment cable connections that are, once terminated, never handled again.
- All changes, circuit rerouting, upgrades, maintenance and other activities are accomplished using semi-permanent patch cords on the front of the EDF cross-connect bay.

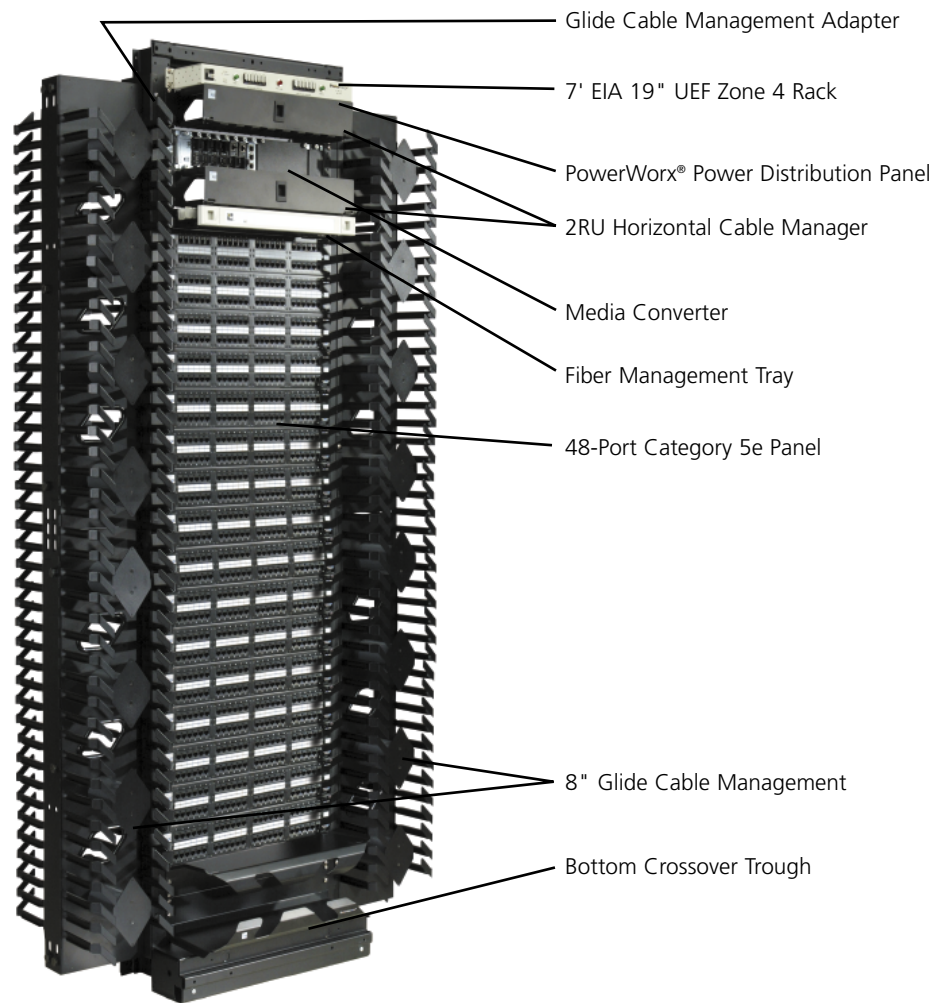



Copper Cable Management Solutions

Vertical and Horizontal Cable Management

Glide Cable Manager

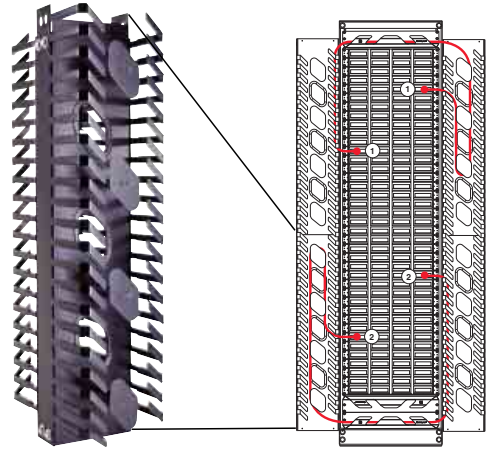

Upper and lower crossover managers with vertical cable managers enable easy, intuitive cable routing.

Features

- Integrated front, rear, horizontal, and vertical cable management
- Patented rib cage design eliminates horizontal support trays and bars
- Supports up to 912 ports on a single rack
- Built-in bend radius protection ensures network integrity
- Designed for quick and easy moves, adds, and changes
- Optional slack managers available for 6-, 8-, 10-, and 12-inch widths
- Fits standard EIA rack with three-inch channel
- Used for single rack or as inter-rack unit
- Optional crossover troughs and horizontal cable managers available
- Optional EIA-standard horizontal support bars available



Copper Cable Management Solutions

Vertical and Horizontal Cable Management

Glide Cable Manager

Ordering Information

Description	Catalog Number
Glide cable manager, vertical mount— <i>to equip both sides of a 7-foot rack, order two Glide Cable Manager units</i> 6", front only, without slack manager 6", front only, with slack manager 6", without slack manager 8", without slack manager 10", without slack manager 12", without slack manager 6", with slack manager 8", with slack manager 10", with slack manager 12", with slack manager Crossover trough, 2RU Crossover trough, 4RU	ADCCMVIB06F-2 ADCCMVIBS06F-2 ADCCM-06 ADCCM-08 ADCCM-10 ADCCM-12 ADCCMS-06 ADCCMS-08 ADCCMS-10 ADCCMS-12 ADCCMTG02 ADCCMTG04
Hinged black metal cover kits: <i>to equip both sides of a 7' rack (front and back), order 2 cover kits.</i> 41" x 6" 41" x 8" 41" x 10" 41" x 12"	ADCCMVIBC06B4 ADCCMVIBC08B4 ADCCMVIBC10B4 ADCCMVIBC12B4
Hinged black metal cover kits: <i>to equip both sides of a 7' rack (front only), order 2 cover kits. These covers are for Glide Cable Managers ADCCMVIB06F-2 and ADCCMVIBS06F-2 only.</i> 41" x 6", two per pack	ADCC06-2



Glide Cable Manager shown in cabinet



Cover in black metal

Ordering Information

Description	Catalog Number
Glide cable manager, cabinet mount— ships 4 per pack 6" x 10RU 6" x 20RU	ADCCMVIB-CB10-4 ADCCMVIB-CB-4
Glide cable manager, cabinet mount, with cable retention—ships 4 per pack 3" x 20RU 6" x 20RU	ADCCMVIB-3CB20-4 ADCCMVIB-6CB20-4

Notes: Equips standard 7' cabinet with front or rear cable management.
Order two 4-packs to equip front and rear of cabinet.

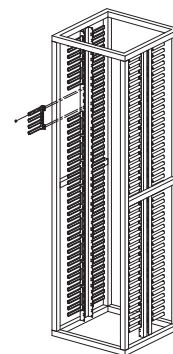

Glide Cable Manager, cabinet mount



Copper Cable Management Solutions

Vertical and Horizontal Cable Management

Glide Cable Manager

Ordering Information

Description	Catalog Number
Crossover troughs 2RU, black 4RU, black, 23" rack 4RU, black	ADCCMTG02 ADCCMTG04-23 ADCCMTG04
Horizontal cable managers 2RU 3RU 4RU With slack managers, 3RU With slack managers, 4RU	ADCCMHIB-2U ADCCMHIB-3U ADCCMHIB-4U ADCCMHIBS-3U ADCCMHIBS-4U
Rear cable management bar, 19" 1" extension	ADCCMRSB
Rear cable management bar, 19" 4" extension	ADCCMRSB-4
Slack manager	ADCCMVIBSP
Stabilizers 6.18" 8.38" 10.18" 12.18"	ADCCMVESB06 ADCCMVESB08 ADCCMVESB10 ADCCMVESB12
Extender brackets, 19" to 23" 1RU 2RU 4RU	EB-17B EB-35B EB-70B



2RU crossover trough



4RU crossover trough



Horizontal cable manager



Stabilizer



Slack manager

Note: Stabilizer used at end of lineup for each Vertical Integrator section.

Ordering Information

Description	Spacing	Catalog Number
7' equipment racks Self-assembly aluminum relay rack, 3" channel Black Brushed aluminum Welded steel relay rack, 3" channel, black Welded steel relay rack, Zone 4 rated, black Unequal flange Network unequal flange	19" EIA 19" EIA 19" EIA 19" EIA 23" EIA	ADCRACKBLK73 ADCRACKMF73 ADCRACKBLK73WS ADCRACKBLK73UE-75 PWUEF-7ERN-BLK



Copper Cable Management Solutions

Vertical and Horizontal Cable Management

Finger Duct Front Managers

ADC's Front Managers are great for organizing patch cords with modular patch panels. They fit on a standard EIA 19" equipment rack. The managers are made of UL 94V-0 plastic and include a snap-on cover.



Finger Duct Front Manager, 1.5"x 3"

Ordering Information

Description	Dimensions (HxWxD)	Catalog Number
1.5"x 3" Front Manager, <i>Pack Quantity: 1</i>	1.75" x 19" x 3.5" (44.45mm x 482.6mm x 88.9mm)	6652 2 153-00
3"x 3" Front Manager, <i>Pack Quantity: 1</i>	3.5" x 19" x 3.5" (88.9mm x 482.6mm x 88.9mm)	6652 2 330-00

Finger Duct Front and Rear Managers

These large capacity managers provide ample room for organizing both incoming cables and patch cords with modular patch panels. They fit on a standard EIA 19" equipment rack. The managers are made of UL 94V-0 plastic and include snap-on covers.



Finger Duct Front and Rear Manager,
3"x 3" Front and 3"x 4" Rear

Ordering Information

Description	Dimensions (HxWxD)	Catalog Number
1.5"x 3" Front Manager and 1"x 4" Rear Manager, <i>Pack Quantity: 1</i>	1.75" x 19" x 3.5" (44.45mm x 482.6mm x 88.9mm)	6652 2 153-14
3"x 3" Front Manager and 2"x 4" Rear Manager, <i>Pack Quantity: 1</i>	3.5" x 19" x 3.5" (88.9mm x 482.6mm x 88.9mm)	6652 2 330-24
3"x 3" Front Manager and 3"x 4" Rear Manager, <i>Pack Quantity: 1</i>	3.5" x 19" x 4.5" (88.9mm x 482.6mm x 114.3mm)	6652 2 330-34



Copper Cable Management Solutions

Vertical and Horizontal Cable Management

Vertical Cable Manager for 7' Equipment Racks

ADC's Vertical Cable Manager mounts between standard 7' equipment racks to provide neat and orderly routing of cables and jumpers.

Each Vertical Cable Manager includes two covers, front and rear. The fingers in the channel are spaced to provide easy entrance and exit of cables while still maintaining control of the cable bend radii. For increased accessibility, the fingers break away, leaving a smooth edge for the protection of cable jackets. Mounting brackets are included.

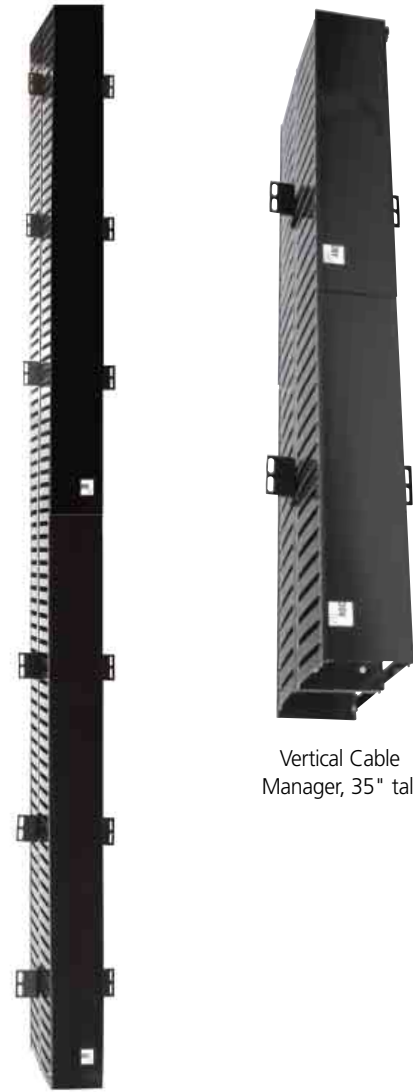

Vertical Cable Manager, 35" tall

Vertical Cable Manager, 83" tall

Ordering Information

Description	Dimensions (HxWxD)	Catalog Number
4"x 5" Front and 4"x 5" Rear Manager, 35" Tall, <i>Pack Quantity: 1</i>	34.6" x 4" x 5" (878.84mm x 101.6mm x 127.0mm)	6652 2 452-35
4"x 5" Front and 4"x 5" Rear Manager, 83" Tall, <i>Pack Quantity: 1</i>	34.6" x 4" x 5" (878.84mm x 101.6mm x 127.0mm)	6652 2 452-83



Copper Cable Management Solutions

Termination Block Mounting Hardware

Introduction

Mounting hardware is available for either wall or rack mount applications. Included is a full range of mounting system hardware and backboards, cable management hardware, mounting frames and support bars, as well as comprehensive fiber optic cable raceway systems for overhead and Plenum applications.

To better understand how the hardware can be utilized, the reference guide on this page gives appropriate use information. The icons shown within the reference chart represent the following equipment:



= Universal Mounting System (UMS)

89D



= Type 89D Mounting Bracket

85



= Type 85 Rod Mount Bracket



= Type 105 Rod Mount Bracket

85



= Type 85 Back Mount Frame







105



= Type 105 Back Mount Frame

Features

- Various options provide flexibility
- Fit standard 19-, 23- and 35.5-inch equipment racks
- Mounting hardware and backboards available for either wall or rack mounting
- Wire management built-in, or available as accessories
- Most ADC blocks have a minimum of two mounting options

Block/Patch Panel						
Ultim8™ Block	•			•		•
HighBand® 10-Pair Block	•			•		•
Feed-Thru (FT) Block	•					
Series 2 Block, 8-Pair			•		•	
Series 2 Block, 10-Pair	•			•		•
25/50-Pair Block		•				
UMS/Mini Patch Panel, Type 105	•			•		•



Copper Cable Management Solutions

Termination Block Mounting Hardware

Universal Mounting System (UMS)

The Universal Mounting System accepts Ultim8™, HighBand® 10, 10-pair Series 2, and 25-pair FT (Feed-Thru) blocks and UMS/Mini patch panels. It is a rugged, low cost, versatile alternative to traditional mounting systems. Besides providing a sturdy, easy-to-install interlinking foundation, the UMS features built-in wire and cable management, and convenient add-ons.

The mounting brackets interlink left-to-right and top-to-bottom to provide a foundation that is easy to install and easy to expand. The brackets are suitable for both rack and wall mount installations.

For fast installation, use the push rivets provided with the UMS backboard to attach the UMS brackets to the backboards.



UMS In Type 105 position



UMS In Type 160 position

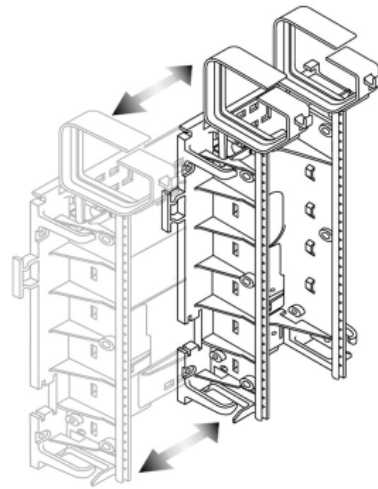

The UMS easily expands from the Type 105 position to the Type 160 position.

Ordering Information

Description	Dimensions (HxWxD)	Catalog Number
UMS Basic Kit Includes one pair of adjustable universal mounting brackets (holds up to 13 Ultim8 blocks and/or label holders), two horizontal wire managers, and appropriate screws and rivets. Typical installation holds 96 pairs using (12) 8-pair Ultim8 blocks (24-ports) and (1) Type 105 label holder. Kit mounts directly to a wall, or to an optional rack or wall mount backboard. <i>Quantity: 1</i>	14.75" x 8.25 x 5.25" (374.7mm x 209.6mm x 133.4mm)	
UMS Basic Kit; Black		6657 2 165-40
UMS Basic Kit; Gray		6657 2 165-00



Copper Cable Management Solutions

Termination Block Mounting Hardware

Universal Mounting System (UMS) Cable and Wire Managers



Vertical cable manager

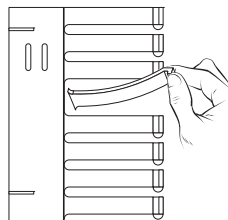

Individual ribs on the vertical cable manager remove to provide additional room for routing patch cords or cables.

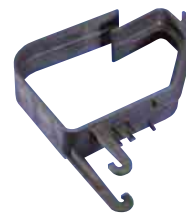

Horizontal wire manager

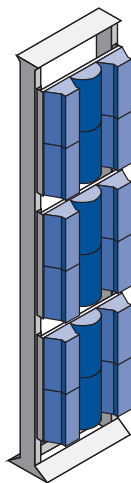

19" equipment rack with three dual height backboards, each holding four Type 105 Universal Mounting Brackets and two vertical cable managers (1,152 pairs or 288 ports).

Connect here for
Ultim8 blocks

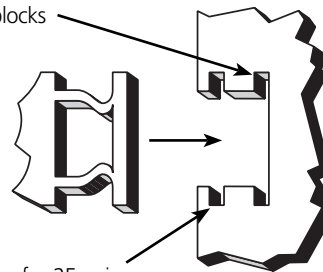

Connect here for 25-pair
FT blocks

Ordering information follows on the next page

Tech Tip

When connecting two UMS brackets, use the inner slot for HighBand blocks or 10-pair Series 2 blocks (Type 105) and the outer slot for 25-pair FT blocks (Type 160).



Copper Cable Management Solutions

Termination Block Mounting Hardware

Universal Mounting System (UMS) Cable and Wire Managers

Ordering Information

Description	Dimensions (HxWxD)	Catalog Number
UMS Vertical Cable Manager Same footprint as the universal mounting bracket in the Type 105 position; provides additional cable management for larger installations or for patch cords. Unique restraining-finger design ensures cables remain in the channel, even with the cover removed. Interlinking tabs, left-to-right and top-to-bottom, match interlinking tabs on the universal mounting bracket. <i>Quantity: 1</i>	11.88" x 8.25" x 5.25" (301.6mm x 209.6mm x 133.4mm)	
UMS Vertical Cable Manager; Black		6657 2 005-44
UMS Vertical Cable Manager; Gray		6657 2 005-04
Horizontal Wire Manager Includes individual horizontal wire manager and two nylon rivets to lock manager in position on UMS bracket. Attaches to top or bottom of UMS bracket. Two managers are included with each UMS basic kit; additional managers are spares or provide wire management along the bottom of an installation. <i>Quantity: 1</i>	5.38" x 1" x 5" (136.5mm x 25.4mm x 127.0mm)	
Horizontal Wire Manager; Black		6657 2 005-43
Horizontal Wire Manager; Gray		6657 2 005-03



Copper Cable Management Solutions

Termination Block Mounting Hardware

Universal Mounting System (UMS) Backboards

UMS backboards provide a base for UMS brackets, and are available in standard equipment rack widths. Each width is available in single or dual height, holding one or two rows of mounting brackets, respectively. Backboards are black and match UMS brackets and cable managers.

Backboards will hold combinations of mounting brackets in both Type 105 (Ultim8™ and HighBand®) and Type 160 (Feed-Thru) positions. Rotate backboards with mixed types 180° to reverse the order of mounting. Silk-screening identifies which holes to use in different mounting configurations.

Wall mount backboards provide the same mounting base as the rack mount backboards but provide a deeper channel. They stand four inches (rather than 1.5 inches) off the wall to allow for proper cable routing. Silk screening indicates correct installation of the UMS adjustable mounting brackets.

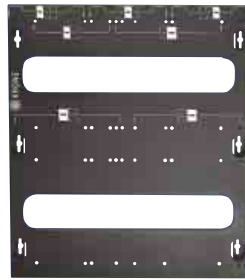

19" backboard, dual height



19" backboard, single height

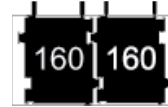
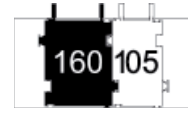
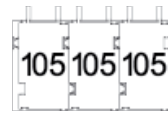

19" configurations

23" configurations

Ordering Information

Description	Dimensions (HxWxD)	Rack	Wall	Catalog Number	
				Black	Gray
UMS backboard Backboards ship one to a package	11.5" x 19" x 1.5"	•		6652 2 080-19	6652 2 069-19
	23" x 19" x 1.5"	•		6652 2 081-19	6652 2 070-19
	11.5" x 19" x 4"	•	•	6652 2 082-19	6652 2 067-19
	23" x 19" x 4"	•	•	6652 2 083-19	6652 2 068-19
	11.5" x 23" x 1.5"	•		6652 2 080-23	6652 2 069-23
	23" x 23" x 1.5"	•		6652 2 081-23	6652 2 070-23



Copper Cable Management Solutions

Termination Block Mounting Hardware

Universal Mounting System (UMS) High Volume Cable Managers

For larger installations, the high volume cable manager provides greater capacity and strength than horizontal wire managers that attach directly to UMS brackets.

Available in widths to match standard equipment racks, the high volume cable manager can be either rack or wall mounted. The manager includes a back mounting plate and a set of six-inch by six-inch rings. The number and position of rings vary to allow use of the manager with a variety of UMS configurations. Mounting holes across the face of the mounting plate allow the position of rings to change to match the varying widths of UMS brackets in either Type 105 or Type 160 positions.

Designed as a companion to the universal mounting system, the high volume cable manager works in any application.



19" cable manager with 3 rings



35.5" cable manager with 6 rings



19" high volume cable manager with 4 rings, shown mounted above 3 Type 105 mounting brackets.



35.5" high volume cable manager with 5 rings, shown mounted above 5 Type 105 mounting brackets.

Ordering Information

Description	Dimensions (HxWxD)	Catalog Number
19" cable manager , black only <i>Quantity: 1</i>	6" x 19" x 6.5" (152.4mm x 482.6mm x 165.1mm)	
3 rings		6657 2 005-19/03
4 rings		6657 2 005-19/04
23" cable manager , black only <i>Quantity: 1</i>	6" x 23" x 6.5" (152.4mm x 584.2mm x 165.1mm)	
3 rings		6657 2 005-23/03
4 rings		6657 2 005-23/04
35.5" cable manager , black only <i>Quantity: 1</i>	6" x 35.5" x 6.5" (152.4mm x 901.7mm x 165.1mm)	
4 rings		6657 2 005-35/04
5 rings		6657 2 005-35/05
6 rings		6657 2 005-35/06
6.5" cable manager , gray only; 2 rings <i>Quantity: 1</i>	6.5" x 6.5" x 4.75" (165.1mm x 165.1mm x 120.65mm)	6657 2 006-06/02
9" cable manager , gray only; 3 rings <i>Quantity: 1</i> Designed to fit directly above UMS in Type 160 position	6.5" x 9.1" x 4.75" (165.1mm x 231.14mm x 120.65mm)	6657 2 006-09/03



Copper Cable Management Solutions

Termination Block Mounting Hardware

Type 85 Back Mount Frames

Type 85 back mount frames accept 8-pair Series 2 blocks. The frames come with cable entry holes on the back and protective rubber grommets. Grommet holes are 1.5" (38.1mm) in diameter. Back mount frames are made of stainless steel.



Type 85 back mount frame
Note: The depth dimensions listed are the actual depths of mounting brackets with no blocks installed.

Ordering Information

Description	Dimensions (HxWxD)	Catalog Number
Type 85 back mount frames <i>Quantity: 1</i>		
6 block positions, 1 hole	5.25" x 3.31" x 2.75" (133.3mm x 84.1mm x 69.9mm)	6654 2 350-06/1
11 block positions, 1 hole	9.63" x 3.31" x 2.75" (244.5mm x 84.1mm x 69.9mm)	6654 2 350-11/1
21 block positions, 2 holes	18.38" x 3.31" x 2.75" (466.7mm x 84.1mm x 69.9mm)	6654 2 350-21/2



Copper Cable Management Solutions

Termination Block Mounting Hardware

Type 105 Back Mount Frames

Type 105 back mount frames accept Ultim8™, HighBand® 10 and 10-pair Series 2 blocks and Type 105 UMS/Mini patch panels. The frames come with cable entry holes on the back and protective rubber grommets. Grommet holes are 1.5-inches (38.1mm) in diameter. Back mount frames are made of stainless steel.



Type 105 back mount frame
Note: The depth dimensions listed are the actual depths of mounting brackets with no blocks installed.

Ordering Information

Description	Dimensions (HxWxD)	Catalog Number
Type 105 back mount frames <i>Quantity: 1</i>		
6 block positions, 1 hole	5.25" x 4.06" x 2.75" (133.3mm x 103.2mm x 69.9mm)	6655 2 450-06/1
11 block positions, 1 hole	9.63" x 4.06" x 2.75" (244.5mm x 103.2mm x 69.9mm)	6655 2 450-11/1
21 block positions, 2 holes	18.38" x 4.06" x 2.75" (466.7mm x 103.2mm x 69.9mm)	6655 2 450-21/2
31 block positions, 3 holes	27.13" x 4.06" x 2.75" (689.0mm x 103.2mm x 69.9mm)	6655 2 450-31/3



Copper Cable Management Solutions

Termination Block Mounting Hardware

Type 105 Back Mount Frames with Ground Lug

These back mount frames have a standard 2.0-inch (50mm) channel depth and come with an attached ground lug.



Back mount frame with ground lug (21-position shown)

Ordering Information

Description	Dimensions (HxWxD)	Catalog Number
Type 105 back mount frames <i>Quantity: 1</i>		
6 block positions, 1 hole	5.25" x 4.06" x 2.75" (133.3mm x 103.2mm x 69.9mm)	6655 2 400-03
21 block positions, 1 hole	18.38" x 4.06" x 2.75" (466.7mm x 103.2mm x 69.9mm)	6655 2 400-00



Copper Cable Management Solutions

Termination Block Mounting Hardware

Type 85 Rod Mount Brackets

Type 85 rod mount brackets accept 8-pair Series 2 rod mount blocks. Install rod mount brackets using support bars, or directly to a plywood backboard.



Type 85 rod mount bracket

Ordering Information

Description	Dimensions (HxWxD)	Catalog Number
Type 85 rod mount brackets <i>Quantity: 1</i>		
6 block positions	5.5" x 4.19" x 2" (139.7mm x 106.4mm x 50.8mm)	6652 2 039-06
11 block positions	9.88" x 4.19" x 2" (250.8mm x 106.4mm x 50.8mm)	6652 2 039-11
21 block positions	18.63" x 4.19" x 2" (473.1mm x 106.4mm x 50.8mm)	6652 2 039-21



Copper Cable Management Solutions

Termination Block Mounting Hardware

Type 105 Rod Mount Brackets

Type 105 rod mount brackets accept Ultim8™, HighBand® 10 and 10-pair Series 2 rod mount blocks and 105mm UMS/Mini Patch Panels. Install rod mount brackets using support bars, or directly to a plywood backboard.



Type 105 rod mount bracket

Ordering Information

Description	Dimensions (HxWxD)	Catalog Number
Type 105 rod mount brackets <i>Quantity: 1</i>		
6 block positions	5.5" x 4.19" x 2" (139.7mm x 106.4mm x 50.8mm)	6652 2 040-06
11 block positions	9.88" x 4.19" x 2" (250.8mm x 106.4mm x 50.8mm)	6652 2 040-11
21 block positions	18.63" x 4.19" x 2" (473.1mm x 106.4mm x 50.8mm)	6652 2 040-21

Rod Mount Bracket Spacer

Rod mount bracket spacers are optional pieces that snap over the 0.47-inch (12mm) rods to maintain uniform distances between rod mount blocks.

Ordering Information

Description	Catalog Number
Rod mount bracket spacer <i>Quantity: 1</i>	
0.1" (2.5mm)	6619 2 046-00
0.2" (5.0mm)	6619 2 046-01

Tech Tip

Rod mount brackets can be easily changed from the Type 85 position to the Type 105 position (or vice versa) by removing the four screws, moving the rods in or out, and reinstalling the screws.



Copper Cable Management Solutions

Mounting Frames

Wall or Rack Mount Mounting Frames

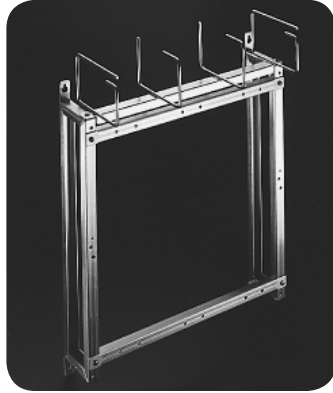

19" wide mounting frame



23" wide mounting frame



35.5" wide mounting frame

Ordering Information

Description	Dimensions (HxWxD)	Catalog Number
19" mounting frame, 3-position <i>Quantity: 1</i> Supports up to (3) 21-position Type 85 or Type 105 mounting brackets; can be wall or rack mounted (EIA standard 19" equipment rack; 3 mounting frames fit vertically in 7' rack) with 4 mounting screws (included). Fixed jumper routing rings included	25" x 19.38" x 4.25" (635mm x 492.1mm x 108mm)	6652 2 100-00
23" mounting frame, 3-position <i>Quantity: 1</i> Supports up to (3) 21-position Type 85 or Type 105 mounting brackets; can be wall or rack mounted (23" equipment rack) with 4 mounting screws (included). Fixed jumper routing rings included	25" x 24" x 4.25" (635mm x 609.6mm x 108mm)	6652 2 114-00
23" mounting frame, 4-position <i>Quantity: 1</i> Supports up to (4) 21-position Type 85 or Type 105 mounting brackets; can be wall or rack mounted (23" equipment rack) with 4 mounting screws (included). Fixed jumper routing rings included	25" x 24" x 4.25" (635mm x 609.6mm x 108mm)	6652 2 113-00
35.5" mounting frame, 5-position <i>Quantity: 1</i> Supports up to (5) 21-position Type 85 or Type 105 mounting brackets; can be wall or rack mounted (23" equipment rack) with 4 mounting screws (included). Fixed jumper routing rings included	26.5" x 35.5" x 4.25" (673.1mm x 901.7mm x 108mm)	6652 2 101-00



Copper Cable Management Solutions

Support Bars

Wall or Rack Mount Support Bars

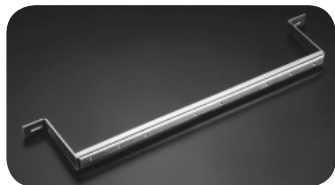

19" wide support bar with 4" leg



23" wide support bar, 3-position



35.5" wide support bar

Ordering Information

Description	Dimensions (HxWxD)	Catalog Number
19" wide support bar, 3-position <i>Quantity: 1</i> <i>2 required for installation</i> (2) 19" wide support bars hold up to (3) Type 85 or Type 105 back mount frames; can be wall or rack mounted (standard 19" equipment rack)		
2" leg (rack mount)	1" x 20" x 2" (25.4mm x 508mm x 50.8mm)	6652 2 021-00
4" leg (wall mount)	1" x 20" x 4" (25.4mm x 508mm x 101.6mm)	6652 2 023-02
23" wide wall mount support bar, 3-position <i>Quantity: 1</i> <i>2 required for installation</i> (2) 23" wide support bars hold up to (3) Type 85 or Type 105 back mount frames		
4" leg (wall mount)	1" x 24" x 4" (25.4mm x 609.6mm x 101.6mm)	6652 2 004-56
23" wide support bar, 4-position <i>Quantity: 1</i> <i>2 required for installation</i> (2) 23" wide support bars hold up to (4) Type 85 or 105 back mount frames; can be wall or rack mounted (standard 23" equipment rack)		
2" leg (rack mount)	1" x 24" x 2" (25.4mm x 609.6mm x 50.8mm)	6652 2 012-45
4" leg (wall mount)	1" x 24" x 4" (25.4mm x 609.6mm x 101.6mm)	6652 2 012-42
35.5" wide support bar <i>Quantity: 1</i> <i>2 required for installation</i> (2) 35.5" wide support bars hold up to (6) Type 85 or (5) Type 105 back mount frames; can be wall or rack mounted (standard 35.5" equipment rack)		
2" leg (rack mount)	1" x 35.69" x 2" (25.4mm x 906.5mm x 50.8mm)	6652 2 013-00
4" leg (wall mount)	1" x 36" x 4" (25.4mm x 914.4mm x 101.6mm)	6652 2 014-00



Copper Cable Management Solutions

Inverted Support Bars

Type 85 and Type 105 Inverted Support Bars

Inverted support bars are designed for equipment cabinets in which terminations must be flush with the front of the equipment rack.



19" wide inverted support bar,
3-position



19" wide inverted support bar,
4-position



23" wide inverted support bar,
3-position

Ordering Information

Description	Dimensions (HxWxD)	Catalog Number
19" wide support bar, 4" legs <i>Quantity: 1 2 required for installation</i>		
3-position Supports up to (3) Type 85 or Type 105 mounting brackets	1" x 20" x 4" (25.4mm x 508mm x 50.8mm)	6652 2 004-54
4-position Supports up to (4) Type 85 mounting brackets	1" x 20" x 4" (25.4mm x 508mm x 101.6mm)	6652 2 004-30
23" wide inverted support bar, 4" legs <i>Quantity: 1 2 required for installation</i> Supports up to (3) Type 85 or Type 105 mounting brackets	1" x 24" x 4" (25.4mm x 609.6mm x 101.6mm)	6652 2 004-57



Copper Cable Management Solutions

Jumper Ring Bars

Jumper ring bars are used with support bars to route cross-connect jumper wires and patch cords.

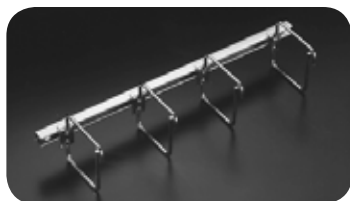

19" wide jumper ring bar,
no legs (wall mount)



23" wide jumper ring bar
no legs (wall mount)



35.5" wide jumper ring bar
no legs (wall mount)



19" wide jumper ring bar
2" legs (rack mount)



23" wide jumper ring bar
2" legs (rack mount)



35.5" wide jumper ring bar
2" legs (rack mount)

Ordering Information

Description	Dimensions (HxWxD)	Catalog Number
19" wide jumper ring bar <i>Quantity: 1</i> 4 adjustable jumper rings		
No legs (wall mount)	4.44" x 20" x 5.18" (112.8mm x 508mm x 131.6mm)	6652 2 004-00
2" legs (rack mount)	4.44" x 20" x 7.18" (112.8mm x 508mm x 182.4mm)	6652 2 004-01
23" wide jumper ring bar <i>Quantity: 1</i> 4 adjustable jumper rings		
No legs (wall mount)	4.44" x 24" x 5.18" (112.8mm x 609.6mm x 131.6mm)	6652 2 006-09
2" legs (rack mount)	4.44" x 24" x 7.18" (112.8mm x 508mm x 182.4mm)	6652 2 006-08
35.5" wide jumper ring bar <i>Quantity: 1</i> 7 adjustable jumper rings		
No legs (wall mount)	4.44" x 36" x 5.18" (112.8mm x 914.4mm x 131.6mm)	6652 2 006-00
2" legs (rack mount)	4.44" x 36" x 7.18" (112.8mm x 914.4mm x 182.4mm)	6652 2 015-00



Copper Cable Management Solutions

Accessories



Vertical cable organizer



High-density cable manager



Horizontal cable organizer

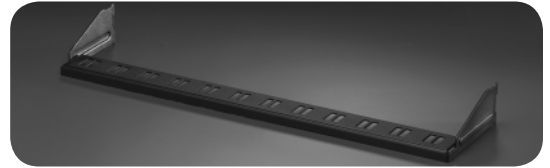

High-density cable manager for patch panels



Rear wire management guide



Ring wire manager

Ordering information follows on the next page



Copper Cable Management Solutions

Accessories

Ordering Information

Description	Dimensions (HxWxD)	Catalog Number
Vertical cable organizer <i>Quantity: 1</i> Fits standard EIA 19" equipment rack; keeps patch cords and smaller wire groups organized within each bay	3.5" x 20" x 4.75" (88.9mm x 508mm x 120.65mm)	6653 2 701-02
Horizontal cable organizer <i>Quantity: 1</i> Fits standard EIA 19" equipment rack; keeps larger wire groups organized between bays	3.5" x 19" x 4.25" (88.9mm x 482.6mm x 186.95mm)	6653 2 701-03
Rear wire management guide <i>Quantity: 1</i> Attaches to back of standard EIA 19" equipment rack; allows organization of hidden wires and cables. <i>Recommended for use with Plug 'n' Play patch panels only. One required for every 24-port group</i>	1.13" x 19" x 1.13" (28.7mm x 482.6mm x 28.7mm)	6653 2 703-00
High-density cable manager <i>Quantity: 1</i> Attaches to standard EIA 19" equipment rack; includes (2) 12-24 screws for mounting to rack. Manages terminated cables on rear of high-density patch panels. 0.5" flange provides flat tie point. Smooth surface prevents snagging and protects against damage	1" x 19" x 4" (25.4mm x 482.6mm x 101.6mm)	6653 2 703-10
High-density cable manager for patch panels <i>Quantity: 1</i> Manages terminated cables on rear of PCB patch panel. Attaches to Category 6 and Category 5e silk-screened and fascia patch panels	1.75" x 19" x 4" (25.4mm x 482.6mm x 101.6mm)	6653 3 585-01
Ring wire manager <i>Quantity: 1</i> Utilizes 5 wire management rings	1.75" x 19" x 3.75" (44.45mm x 482.6mm x 91.88mm)	6653 2 700-03
Hinged wall mount bracket <i>Quantity: 1</i> Allows easy access to cable side of patch panel for circuit tracing or wiring re-termination. For left or right swing opening; simple push-pull latch keeps the panel secure in closed position		
3.5" hinged wall mount bracket Accepts (2) 1RU or (1) 2RU patch panel	3.5" x 19" x 5" (88.9mm x 914.4mm x 131.6mm)	6653 2 701-00
7" hinged wall mount bracket Accepts any 4RU combination of patch panels	7" x 19" x 5" (177.8mm x 482.6mm x 127mm)	6653 2 701-01